



RECOMMENDED PRACTICE:
LIGHTING HOSPITALITY SPACES
AN AMERICAN NATIONAL STANDARD

Currently in preview, click buy full version



Currently in preview, click buy full version

ANSI/IES RP-9-23

**RECOMMENDED PRACTICE:
LIGHTING HOSPITALITY SPACES
AN AMERICAN NATIONAL STANDARD**

Publication of this document
has been approved by IES.
Suggestions for revisions
should be directed to IES.

**Prepared for IES by the
IES Hospitality Lighting Committee**



Copyright 2023 by the Illuminating Engineering Society.

Approved by the IES Standards Committee Oct. 28, 2022, as a Transaction of the Illuminating Engineering Society.

Approved Jan. 24, 2023, as an American National Standard.

All rights reserved. No part of this publication may be reproduced in any form, in any electronic retrieval system or otherwise, without prior written permission of the IES.

Published by the Illuminating Engineering Society, 120 Wall Street, New York, New York 10005.

IES Standards are developed through committee consensus and produced by the IES Office in New York. Careful attention is given to style and accuracy. If any errors are noted in this document, please forward them to the Director of Standards, at standards@ies.org or the above address, for verification and correction. The IES welcomes and urges feedback and comments.

Printed in the United States of America.

ISBN 978-0-87995-451-2

DISCLAIMER

IES publications are developed through the consensus standards development process approved by the American National Standards Institute. This process brings together volunteers representing varied viewpoints and interests to achieve consensus on lighting recommendations. While the IES administers the process and establishes policies and procedures to promote fairness in the development of consensus, it makes no guaranty or warranty as to the accuracy or completeness of any information published herein.

The IES disclaims liability for any injury to persons or property or other damages of any nature whatsoever, whether special, indirect, consequential or compensatory, directly or indirectly resulting from the publication, use of, or reliance on this document.

In issuing and making this document available, the IES is not undertaking to render professional or other services for or on behalf of any person or entity. Nor is the IES undertaking to perform any duty owed by any person or entity to someone else. Anyone using this document should rely on his or her own independent judgment or, as appropriate, seek the advice of a competent professional in determining the exercise of reasonable care in any given circumstances.

The IES has no power, nor does it undertake, to police or enforce compliance with the contents of this document. Nor does the IES list, certify, test or inspect products, designs, or installations for compliance with this document. Any certification or statement of compliance with the requirements of this document shall not be attributable to the IES and is solely the responsibility of the certifier or maker of the statement.

AMERICAN NATIONAL STANDARD

Approval of an American National Standard requires verification by ANSI that the requirements for due process, consensus, and other criteria have been met by the standards developer.

Consensus is established when, in the judgment of the ANSI Board of Standards Review, substantial agreement has been reached by directly and materially affected interests. Substantial agreement means much more than a simple majority, but not necessarily unanimity. Consensus requires that all views and objections be considered, and that a concerted effort be made toward their resolution.

The use of American National Standards is completely voluntary; their existence does not in any respect preclude anyone, whether that person has approved the standards or not, from manufacturing, marketing, purchasing, or using products, processes, or procedures not conforming to the standards.

The American National Standards Institute does not develop standards and will in no circumstances give an interpretation to any American National Standard. Moreover, no person shall have the right or authority to issue an interpretation of an American National Standard in the name of the American National Standards Institute. Requests for interpretations should be addressed to the secretariat or sponsor whose name appears on the title page of this standard.

CAUTION NOTICE: This American National Standard may be revised at any time. The procedures of the American National Standards Institute require that action be taken to reaffirm, revise, or withdraw this standard no later than five years from the date of approval. Purchasers of American National Standards may receive current information on all standards by calling or writing the American National Standards Institute.

Prepared by The IES Hospitality Lighting Committee

Donald J. King, *Chair*

Peter A. Hugh, *Vice Chair*

Members

E. G. Altman

N. Bleeker

A. M. Dugar

J. M. Fox

D. Ghatan

C. Israel

T. Jacobs

A. T. Luong

S. Parish

S. L. Pay

D. G. Rubin

T. C. Scott

C. W. Selander

S. Spaziani

J. E. D. Speck

M. Zukerman

Currently in preview, click buy full version

CONTENTS

Preface	1
1.0 Introduction and Scope	1
1.1 Introduction.....	1
1.2 Scope.....	2
1.2.1 Key Elements of the Design Guide.....	2
1.2.2 Hospitality Segments	3
2.0 Light Sources and Controls	3
2.1 Light Sources.....	3
2.2 Lighting Controls	4
3.0 Exterior areas	4
3.1 Exterior Entrance and Entry Drive	4
3.1.1 Lighting Design Considerations.....	4
3.1.2 Design Criteria and Solutions	5
3.2 Exterior Pool, Spas, and Lounges	6
3.2.1 Lighting Design Considerations.....	6
3.2.2 Design Criteria and Solutions	7
4.0 Lobby	8
4.1 Lighting Design Considerations	9
4.2 Design Criteria and Solutions.....	9
5.0 Elevator Lobbies	13
6.0 Public Corridors	13
7.0 Public Restrooms	14
8.0 Emergency Lighting	15
8.1 Lighting Design Considerations	15
8.2 Design Criteria and Solutions.....	16
9.0 Ballrooms and Multifunction Meeting Rooms	16
9.1 Ballrooms	16
9.1.1 Lighting Design Considerations.....	17
9.1.2 Design Criteria and Solutions	17

9.2 Multifunction Meeting Rooms	18
9.2.1 Lighting Design Considerations.....	19
9.2.2 Design Criteria and Solutions.....	19
10.0 Exhibition Halls	21
10.1 Lighting Design Considerations	21
10.2 Design Criteria and Solutions	21
11.0 Gaming	22
11.1 Gaming areas	22
11.1.1 Lighting Design Considerations.....	22
11.1.2 Design Criteria and Solutions – Table Games.....	23
11.1.3 Design Criteria and Solutions – Poker Rooms.....	24
11.1.4 Design Criteria and Solutions – High-Roller Areas.....	25
11.1.5 Design Criteria and Solutions – Slot Machine Areas.....	25
11.2 Circulation	26
11.2.1 Lighting Design Considerations.....	26
11.2.2 Design Criteria and Solutions.....	26
11.3 Cashiers and Cash Cages	27
11.3.1 Lighting Design Considerations.....	27
11.3.2 Design Criteria and Solutions.....	27
11.4 Sports-Book Betting Areas	27
11.4.1 Lighting Design Considerations.....	27
11.4.2 Design Criteria and Solutions.....	27
11.5 Interactive Games	27
11.6 Exterior Lighting	28
11.6.1 Lighting Design Considerations.....	28
11.6.2 Design Criteria and Solutions.....	28
11.7 Additional Considerations	29
11.7.1 Codes and Standards.....	29
11.7.2 Renovations.....	29
11.7.3 Germicidal Ultraviolet.....	29
12.0 Food and Beverage	29
12.1 Lighting Design Considerations	29
12.2 Design Criteria and Solutions	30
13.0 Retail	32
13.1 Lighting Design Considerations.....	32
13.2 Design Criteria and Solutions.....	34
14.0 Business Center	35
14.1 Lighting Design Considerations.....	35
14.2 Design Criteria and Solutions.....	35
15.0 Spa Services	35
15.1 Lighting Design Considerations.....	36

15.2 Design Criteria and Solutions.....	36
15.2.1 Spa Lobby	36
15.2.2 Spa Treatment Rooms	37
15.2.3 Spa Lockers	38
15.2.4 Spa Makeup and Cosmetics	39
15.2.5 Barber and Beauty Shops.....	39
16.0 Fitness Center	38
16.1 Lighting Design Considerations	38
16.2 Design Criteria and Solutions.....	40
17.0 Guest Corridors	40
17.1 Lighting Design Considerations	41
17.2 Design Criteria and Solutions.....	41
18.0 Guest Rooms	43
18.1 Lighting Design Considerations	43
18.2 Design Criteria and Solutions.....	43
19.0 Guest Bathrooms	45
19.1 Lighting Design Considerations	45
19.2 Design Criteria and Solutions.....	46
Annex A – Illuminance Recommendations	46
Annex B – Color Considerations.....	57
Annex C – Americans with Disabilities Act (A.D.A.) Considerations (U.S.)	57
References	59

Currently in preview, click buy full versi

Preface

This preface is not part of ANSI/IES RP-9-23. It is provided for informational purposes only.

This Recommended Practice (RP) does not provide general lighting information that is included in other IES documents. If the reader does not already have this information, it may be obtained as needed from the following IES Standards:

The Lighting Science Series:

- *ANSI/IES LS-1-22, Lighting Science: Nomenclature and Definitions for Illuminating Engineering*
- *ANSI/IES LS-2-20, Lighting Science: Concepts and Language of Lighting*
- *ANSI/IES LS-3-20, Lighting Science: Physics and Optics of Radiant Power*
- *ANSI/IES LS-4-20, Lighting Science: Measurement of Light – The Science of Photometry*
- *ANSI/IES LS-5-21, Lighting Science: Color*
- *ANSI/IES LS-6-20, Lighting Science: Calculation of Light and Its Effects*
- *ANSI/IES LS-7-20, Lighting Science: Vision – Eye and Brain*
- *ANSI/IES LS-8-20, Lighting Science: Vision – Perceptions and Performance*

The Lighting Practice Series:

- *ANSI/IES LP-1-20, Lighting Practice: Designing Quality Lighting for People and Buildings*
- *ANSI/IES LP-2-20, Lighting Practice: Designing Quality Lighting for People in Outdoor Environments*
- *ANSI/IES LP-3-20, Lighting Practice: Designing and Specifying Daylighting for Buildings*
- *ANSI/IES LP-4-20, Lighting Practice: Electric Light Sources – Properties, Selection, and Specification*
- *ANSI/IES LP-6-20, Lighting Practice: Lighting Control Systems – Properties, Selection, and Specification*
- *ANSI/IES LP-7-20, Lighting Practice: The Lighting Design and Construction Process*
- *ANSI/IES LP-8-20, Lighting Practice: The Commissioning Process Applied to Lighting and Control Systems*
- *ANSI/IES LP-9-20, Lighting Practice: Upgrading Lighting Systems in Commercial and Industrial Facilities*

- *ANSI/IES LP-10-20, Lighting Practice: Sustainable Lighting – An Introduction to the Environmental Impacts of Lighting*
- *ANSI/IES LP-11-20, Lighting Practice: Environmental Considerations for Outdoor Lighting*
- *ANSI/IES LP-12-21, Lighting Practice: IoT Connected Lighting*
- *ANSI/IES LP-13-21, Lighting Practice: Introduction to Resilient Lighting Systems*
- *ANSI/IES LP-16-22, Lighting Practice: Documenting Control Intent Narratives and Sequences of Operations*

1.0 Introduction and Scope

1.1 Introduction

This Recommended Practice (RP) has been developed to aid designers, facility managers, and owners in creating lighting systems for hotel applications. The intent is to address how all of the various components of hospitality lighting need to be an integrated system of layers as well as uniquely represented areas of illumination.

Lighting is critical to commercial success in the hospitality industry. Lighting is often the first feature that guests notice (see **Figures 1-1, 1-2**) and is the element that creates that all-important long-lasting positive impression. This first impression may form guests' opinions about the quality, character, convenience, and charm of the hotel even before they reach the front entrance.

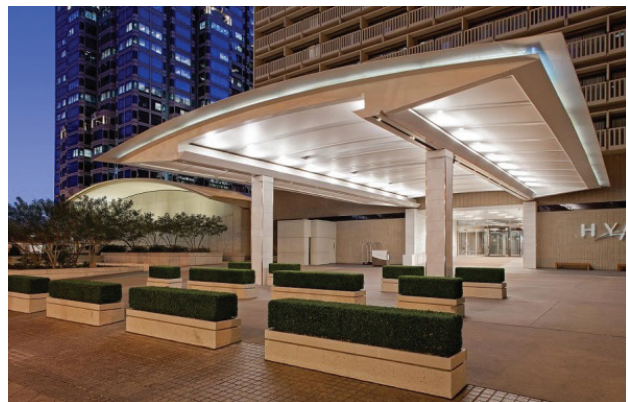

Figure 1-1. Bright porte-cochere lighting announces building entry and provides a sense of arrival.

(Photo courtesy of Peter Hugh)



Figure 1-2. Lighting reinforces building's identity and enhances architectural features. (Photo courtesy of Lighting Design Alliance)

This process of evaluation begins when the hotel is first seen from the street. During the day, it is based on the hotel's architecture and the surrounding area. At night, it is largely based on the way exterior lighting accents the building. Well-designed outdoor lighting identifies the hotel and its entrance and welcomes guests. It also reinforces a feeling of safety and security, and provides a first glimpse of the hotel's interior character and style.

Proper lighting indoors is essential in making sure the guests' impressions continue to be positive. This same principle continues as the guests walk down the corridors, visit their rooms, and have their first meal. Creative and effective lighting in restaurants, bars, and shops attracts more patrons, increases sales, and contributes to revenue growth.

Quality lighting is of the utmost importance to business travelers who work in their rooms and/or in the hotel's conference facilities. Effective, well-designed lighting will make their stay pleasurable and productive, entice them to return, and provide positive word of mouth references, which are excellent advertising. All these factors reinforce the brand and are critical to the success of the property.

In addition to the guest benefits, good lighting also helps the staff work more efficiently and effectively and perform their tasks safely. Here again, lighting can improve productivity and increase the hotel's profitability. Lighting controls add convenience and reduce energy use and operating costs. Light source

and power supply, and luminaire efficiency, placement, and optical performance all affect operating and maintenance costs.

Addressing every lighting issue of the hospitality industry would require a broader format than available here. Therefore, this Recommended Practice (RP) focuses on key areas in hotels and provides recommendations for the technologies and application designs available at the time it was written.

It is important to recognize that all documents are works in progress. While the main objective of lighting design is to serve human needs, and enhance the human experience with high quality lighting, ways to achieve the objective are constantly evolving. Lighting technologies are continually changing. Effective energy utilization and sustainability issues become increasingly important considerations that alter design parameters. Daylighting and controls are becoming increasingly more integrated and complex. Design styles, trends, and the degree of public sophistication continue to evolve, resulting in changes to the way lighting systems are designed.

1.2 Scope

1.2.1 Key Elements of the Recommended Practice.

This document provides guidance specific to lighting design for the following hotel areas:

- Exterior Entrances, Entry Drives,
- Lobbies; Elevator Lobbies
- Public Corridors; Public Restrooms
- Emergency Lighting
- Guest Corridors; Guest Rooms; Guest Bathrooms
- Ballrooms and Multifunction Meeting Rooms
- Exhibition Halls
- Food and Beverage; Retail; Spa Services
- Business Centers
- Fitness Centers

For consistency, each application section follows a standard format. (In addition, all applicable codes, such as the Americans with Disability Act (ADA), described in **Annex C**, and energy and outdoor codes and standards