



**RECOMMENDED PRACTICE:**  
**LIGHTING HOSPITALITY SPACES**  
AN AMERICAN NATIONAL STANDARD

Currently in preview, click buy full version



**ANSI/IES RP-9-20**

**RECOMMENDED PRACTICE:  
LIGHTING HOSPITALITY SPACES  
AN AMERICAN NATIONAL STANDARD**

Publication of this Recommended Practice has been approved by IES. Suggestions for revisions should be directed to IES.

**Prepared by  
The IES Hospitality Lighting Committee**



*Copyright 2020 by the Illuminating Engineering Society.*

*Approved by the IES Standards Committee January 6, 2020 as a Transaction of the Illuminating Engineering Society.*

*Approved March 19, 2020 as an American National Standard.*

*All rights reserved.* No part of this publication may be reproduced in any form, in any electronic retrieval system or otherwise, without prior written permission of the IES.

Published by the Illuminating Engineering Society, 120 Wall Street, New York, New York 10005

IES Standards are developed through committee consensus and produced by the IES Office in New York. Careful attention is given to style and accuracy. If any errors are noted in this document, please forward them to Brian Liebel, Director of Standards, at the above address or [standards@ies.org](mailto:standards@ies.org) for verification and correction. The IES welcomes and urges feedback and comments

Printed in the United States of America.

ISBN# 978-0-87995-067-5

---

## DISCLAIMER

IES publications are developed through the consensus standards development process approved by the American National Standards Institute. This process brings together volunteers representing varied viewpoints and interests to achieve consensus on lighting recommendations. While the IES administers the process, and establishes policies and procedures to promote fairness in the development of consensus, it makes no guaranty or warranty as to the accuracy or completeness of any information published herein.

The IES disclaims liability for any injury to persons or property or other damages of any nature whatsoever, whether special, indirect, consequential or compensatory, directly or indirectly resulting from the publication, use of, or reliance on this document.

In issuing and making this document available, the IES is not undertaking to render professional or other services for or on behalf of any person or entity. Nor is the IES undertaking to perform any duty owed by any person or entity to someone else. Anyone using this document should rely on his or her own independent judgment, or, as appropriate, seek the advice of a competent professional in determining the exercise of reasonable care in any given circumstances.

The IES has no power, nor does it undertake, to police or enforce compliance with the contents of this document. Nor does the IES list, certify, test or inspect products, designs, or installations for compliance with this document. Any certification or statement of compliance with the requirements of this document shall not be attributable to the IES and is solely the responsibility of the certifier or maker of the statement.

## AMERICAN NATIONAL STANDARD

Approval of an American National Standard requires verification by ANSI that the requirements for due process, consensus, and other criteria have been met by the standards developer.

Consensus is established when, in the judgment of the ANSI Board of Standards Review, substantial agreement has been reached by directly and materially affected interests. Substantial agreement means much more than a simple majority, but not necessarily unanimity. Consensus requires that all views and objections be considered, and that a concerted effort be made toward their resolution.

The use of American National Standards is completely voluntary; their existence does not in any respect preclude anyone, whether that person has approved the standards or not, from manufacturing, marketing, purchasing, or using products, processes, or procedures not conforming to the standards.

The American National Standards Institute does not develop standards and will in no circumstances give an interpretation to any American National Standard. Moreover, no person shall have the right or authority to issue an interpretation of an American National Standard in the name of the American National Standards Institute. Requests for interpretations should be addressed to the secretariat or sponsor whose name appears on the title page of this standard.

CAUTION NOTICE: This American National Standard may be revised at any time. The procedures of the American National Standards Institute require that action be taken to reaffirm, revise, or withdraw this standard no later than five years from the date of approval. Purchasers of American National Standards may receive current information on all standards by calling or writing the American National Standards Institute.

**Prepared by The IES Hospitality Lighting Committee**

**Emlyn G. Altman, *Co-chair***

**Donald J. King, *Co-chair***

**Peter A. Hugh, *Vice Chair***

**Neeraj Lal, *Secretary***

**Members**

N. Bleeker

J. M. Fox

D. Ghatan

C. Israel

T. Jacobs

R. R. Leddusire

A. T. Luong

S. Parish

S. L. Pay

D. G. Rubin

T. C. Scott

C. W. Selander

S. Spaziani

J. E. D. Speck

M. Zukerman

**Advisory Members**

S. M. Agosta-Bidleman

A. J. Spata

R. W. Spry

R. E. Valdes

---

# CONTENTS

<b>Foreword</b> .....	1
<b>1.0 Introduction and Scope</b> .....	<b>1</b>
1.1 Introduction.....	1
1.2 Scope .....	2
1.2.1 Key Elements of the Design Guide .....	2
1.2.2 Hospitality Segments .....	3
<b>2.0 Light Sources and Controls</b> .....	<b>3</b>
2.1 Light Sources.....	3
2.2 Lighting Controls.....	3
<b>3.0 Exterior Areas</b> .....	<b>4</b>
3.1 Exterior Entrance and Entry Drive .....	4
3.1.1 Lighting Design Considerations.....	4
3.1.2 Design Criteria and Solutions .....	5
3.2 Exterior Pool, Spas, and Lounges .....	6
3.2.1 Lighting Design Considerations.....	6
3.2.2 Design Criteria and Solutions .....	7
<b>4.0 Lobby</b> .....	<b>8</b>
4.1 Lighting Design Considerations .....	9
4.2 Design Criteria and Solutions .....	9
<b>5.0 Elevator Lobbies</b> .....	<b>13</b>
<b>6.0 Public Corridors</b> .....	<b>13</b>
<b>7.0 Public Restrooms</b> .....	<b>14</b>
<b>8.0 Emergency Lighting</b> .....	<b>15</b>
8.1 Lighting Design Considerations .....	15
8.2 Design Criteria and Solutions .....	16

<b>9.0</b>	<b>Ballrooms and Multifunction Meeting Rooms</b>	<b>16</b>
<b>9.1</b>	<b>Ballrooms</b>	<b>16</b>
9.1.1	Lighting Design Considerations	16
9.1.2	Design Criteria and Solutions	17
<b>9.2</b>	<b>Multifunction Meeting Rooms</b>	<b>18</b>
9.2.1	Lighting Design Considerations	19
9.2.2	Design Criteria and Solutions	19
<b>10.0</b>	<b>Exhibition Halls</b>	<b>20</b>
<b>10.1</b>	<b>Lighting Design Considerations</b>	<b>21</b>
<b>10.2</b>	<b>Design Criteria and Solutions</b>	<b>21</b>
<b>11.0</b>	<b>Gaming</b>	<b>21</b>
<b>11.1</b>	<b>Lighting Design Considerations</b>	<b>21</b>
<b>11.2</b>	<b>Design Criteria and Solutions</b>	<b>22</b>
<b>12.0</b>	<b>Food and Beverage</b>	<b>22</b>
<b>12.1</b>	<b>Lighting Design Considerations</b>	<b>22</b>
<b>12.2</b>	<b>Design Criteria and Solutions</b>	<b>22</b>
<b>13.0</b>	<b>Retail</b>	<b>25</b>
<b>13.1</b>	<b>Lighting Design Considerations</b>	<b>25</b>
<b>13.2</b>	<b>Design Criteria and Solutions</b>	<b>26</b>
<b>14.0</b>	<b>Business Center</b>	<b>28</b>
<b>14.1</b>	<b>Lighting Design Considerations</b>	<b>28</b>
<b>14.2</b>	<b>Design Criteria and Solutions</b>	<b>28</b>
<b>15.0</b>	<b>Spa Services</b>	<b>29</b>
<b>15.1</b>	<b>Lighting Design Considerations</b>	<b>29</b>
<b>15.2</b>	<b>Design Criteria and Solutions</b>	<b>29</b>
15.2.1	Spa Lobby	29
15.2.2	Spa Treatment Rooms	30
15.2.3	Spa Lockers	31
15.2.4	Spa Makeup and Cosmetics	32
15.2.5	Barber and Beauty Shops	32
<b>16.0</b>	<b>Fitness Center</b>	<b>32</b>
<b>16.1</b>	<b>Lighting Design Considerations</b>	<b>32</b>
<b>16.2</b>	<b>Design Criteria and Solutions</b>	<b>33</b>

<b>17.0 Guest Corridors</b> .....	<b>33</b>
17.1 Lighting Design Considerations .....	34
17.2 Design Criteria and Solutions .....	34
<b>18.0 Guest Rooms</b> .....	<b>36</b>
18.1 Lighting Design Considerations .....	36
18.2 Design Criteria and Solutions .....	3
<b>19.0 Guest Bathrooms</b> .....	<b>38</b>
19.1 Lighting Design Considerations .....	38
19.2 Design Criteria and Solutions .....	38
<b>Annex A – Illuminance Recommendations</b> .....	<b>39</b>
<b>Annex B – Color Considerations</b> .....	<b>50</b>
<b>Annex C – Americans with Disabilities Act (A.D.A.) Considerations (U.S.)</b> .....	<b>50</b>
<b>References</b> .....	<b>52</b>

Currently in preview, click buy full versi

## Foreword

This Foreword is not part of ANSI/IES RP-9-20. It is provided for informational purposes only.

This Recommended Practice (RP) does not provide general lighting information that is included in other IES documents. If the reader does not already have this information, it may be obtained as needed from the following IES Standards:

The Lighting Science Series:

- ANSI/IES LS-1-20, *Lighting Science: Nomenclature and Definitions for Illuminating Engineering*
- ANSI/IES LS-2-20, *Lighting Science: Concepts and Language of Lighting*
- ANSI/IES LS-3-20, *Lighting Science: Physics and Optics of Radiant Power*
- ANSI/IES LS-4-20, *Lighting Science: Measurement of Light – The Science of Photometry*
- ANSI/IES LS-5-20, *Lighting Science: Color*
- ANSI/IES LS-6-20, *Lighting Science: Calculation of Light and Its Effects*
- ANSI/IES LS-7-20, *Lighting Science: Vision – Eye and Brain*
- ANSI/IES LS-8-20, *Lighting Science: Vision – Perceptions and Performance*

The Lighting Practice Series:

- ANSI/IES LP-1-20, *Lighting Practice: Designing Quality Lighting for People and Buildings*
- ANSI/IES LP-2-20, *Lighting Practice: Designing Quality Lighting for People in Outdoor Environments*
- ANSI/IES LP-3-20, *Lighting Practice: Designing and Specifying Daylighting for Buildings*
- ANSI/IES LP-4-20, *Lighting Practice: Electric Light Sources – Properties, Selection, and Specification*
- ANSI/IES LP-5-20, *Lighting Practice: Lighting Control Systems – Properties, Selection, and Specification*
- ANSI/IES LP-6-20, *Lighting Practice: Lighting Control Systems – Properties, Selection, and Specification*
- ANSI/IES LP-7-20, *Lighting Practice: The Lighting Design and Construction Process*
- ANSI/IES LP-8-20, *Lighting Practice: The Commissioning Process Applied to Lighting and Control Systems*

- ANSI/IES LP-9-20, *Lighting Practice: Upgrading Lighting Systems in Commercial and Industrial Facilities*
- ANSI/IES LP-10-20, *Lighting Practice: Sustainable Lighting – An Introduction to the Environmental Impacts of Lighting*
- ANSI/IES LP-11-20, *Lighting Practice: Environmental Considerations for Outdoor Lighting*

## 1.0 Introduction and Scope

### 1.1 Introduction

This Recommended Practice (RP) has been developed to aid designers, facility manager, and owners in creating lighting systems for hotel applications. The intent is to address how all of the various components of hospitality lighting need to be an integrated system of layers as well as uniquely represented areas of illumination.

Lighting is critical to commercial success in the hospitality industry. Lighting is often the first feature that guests notice (see **Figures 1-1, 1-2**) and is the element that creates that all-important long-lasting positive impression. This first impression may form guests' opinions about the quality, character, convenience, and charm of the hotel even before they reach the front entrance.

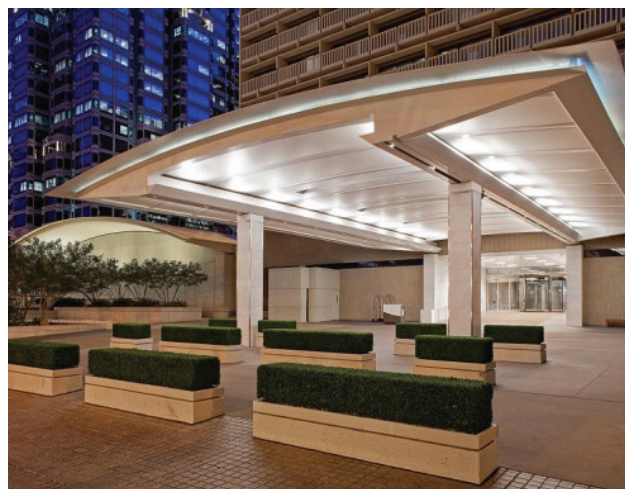

**Figure 1-1. Bright porte-cochere lighting announces building entry and provides a sense of arrival.**

(Photo courtesy of Peter Hugh)