

# IEEE Standard for Robot Map Data Representation for Navigation

IEEE Robotics and Automation Society

Sponsored by the  
Standing Committee for Standardization

Currently in preview, click buy full version

# IEEE Standard for Robot Map Data Representation for Navigation

Sponsor

**Standing Committee for Standards**  
of the  
**IEEE Robotics and Automation Society**

Approved 3 September 2015

**IEEE-SA Standards Board**

Currently in preview, click buy full version

**Abstract:** A map data representation of environments of a mobile robot performing a navigation task is specified in this standard. It provides data models and data formats for two-dimensional (2D) metric and topological maps.

**Keywords:** IEEE 1873™, map data representation, metric map, robot navigation, topological map

---

The Institute of Electrical and Electronics Engineers, Inc.  
3 Park Avenue, New York, NY 10016-5997, USA

Copyright © 2015 by The Institute of Electrical and Electronics Engineers, Inc.  
All rights reserved. Published 26 October 2015. Printed in the United States of America.

IEEE is a registered trademark in the U.S. Patent & Trademark Office, owned by The Institute of Electrical and Electronics Engineers, Inc. incorporated.

W3C is a trademark (registered in numerous countries) of the World Wide Web Consortium; marks of W3C are registered and held by its host institutions MIT, ERCIM, Keio, and Beihang.

PDF: ISBN 978-0-7381-9893-4 STD20357  
Print: ISBN 978-0-7381-9894-1 STDPD20357

*IEEE prohibits discrimination, harassment, and bullying.*

For more information, visit <http://www.ieee.org/web/aboutus/whatis/policies/p9-26.html>.

*No part of this publication may be reproduced in any form, in an electronic retrieval system or otherwise, without the prior written permission of the publisher.*

## Important Notices and Disclaimers Concerning IEEE Standards Documents

IEEE documents are made available for use subject to important notices and legal disclaimers. These notices and disclaimers, or a reference to this page, appear in all standards and may be found under the heading “Important Notice” or “Important Notices and Disclaimers Concerning IEEE Standards Documents.”

### Notice and Disclaimer of Liability Concerning the Use of IEEE Standards Documents

IEEE Standards documents (standards, recommended practices, and guides), both full-use and trial-use, are developed within IEEE Societies and the Standards Coordinating Committees of the IEEE Standards Association (“IEEE-SA”) Standards Board. IEEE (“the Institute”) develops its standards through a consensus development process, approved by the American National Standards Institute (“ANSI”), which brings together volunteers representing varied viewpoints and interests to achieve the final product. Volunteers are not necessarily members of the Institute and participate without compensation from IEEE. While IEEE administers the process and establishes rules to promote fairness in the consensus development process, IEEE does not independently evaluate, test, or verify the accuracy of any of the information or the soundness of any judgments contained in its standards.

IEEE does not warrant or represent the accuracy or content of the material contained in its standards, and expressly disclaims all warranties (express, implied and statutory) not included in this or any other document relating to the standard, including, but not limited to, the warranties of: merchantability; fitness for a particular purpose; non-infringement; and quality, accuracy, effectiveness, currency, or completeness of material. In addition, IEEE disclaims any and all conditions relating to: results; and workmanlike effort. IEEE standards documents are supplied “AS IS” and “WITH ALL FAULTS.”

Use of an IEEE standard is wholly voluntary. The existence of an IEEE standard does not imply that there are no other ways to produce, test, measure, purchase, make, or provide other goods and services related to the scope of the IEEE standard. Furthermore, the viewpoint expressed at the time a standard is approved and issued is subject to change brought about through developments in the state of the art and comments received from users of the standard.

In publishing and making its standards available, IEEE is not suggesting or rendering professional or other services for, or on behalf of, any person or entity nor is IEEE undertaking to perform any duty owed by any other person or entity to another. Any person utilizing any IEEE Standards document, should rely upon his or her own independent judgment in the exercise of reasonable care in any given circumstances or, as appropriate, seek the advice of a competent professional in determining the appropriateness of a given IEEE standard.

IN NO EVENT SHALL IEEE BE LIABLE FOR ANY DIRECT, INDIRECT, INCIDENTAL, SPECIAL, EXEMPLARY, OR CONSEQUENTIAL DAMAGES (INCLUDING, BUT NOT LIMITED TO: PROCUREMENT OF SUBSTITUTE GOODS OR SERVICES; LOSS OF USE, DATA, OR PROFITS; OR BUSINESS INTERRUPTION) HOWEVER CAUSED AND ON ANY THEORY OF LIABILITY, WHETHER IN CONTRACT, STRICT LIABILITY, OR TORT (INCLUDING NEGLIGENCE OR OTHERWISE) ARISING IN ANY WAY OUT OF THE PUBLICATION, USE OF, OR RELIANCE UPON ANY STANDARD, EVEN IF ADVISED OF THE POSSIBILITY OF SUCH DAMAGE AND REGARDLESS OF WHETHER SUCH DAMAGE WAS FORESEEABLE.

### Translations

The IEEE consensus development process involves the review of documents in English only. In the event that an IEEE standard is translated, only the English version published by IEEE should be considered the approved IEEE standard.

## Official statements

A statement, written or oral, that is not processed in accordance with the IEEE-SA Standards Board Operations Manual shall not be considered or inferred to be the official position of IEEE or any of its committees and shall not be considered to be, or be relied upon as, a formal position of IEEE. At lectures, symposia, seminars, or educational courses, an individual presenting information on IEEE standards shall make it clear that his or her views should be considered the personal views of that individual rather than the formal position of IEEE.

## Comments on standards

Comments for revision of IEEE Standards documents are welcome from any interested party, regardless of membership affiliation with IEEE. However, IEEE does not provide consulting information or advice pertaining to IEEE Standards documents. Suggestions for changes in documents should be in the form of a proposed change of text, together with appropriate supporting comments. Since IEEE standards represent a consensus of concerned interests, it is important that any responses to comments and questions also receive the concurrence of a balance of interests. For this reason, IEEE and the members of its societies and Standards Coordinating Committees are not able to provide an instant response to comment or questions except in those cases where the matter has previously been addressed. For the same reason, IEEE does not respond to interpretation requests. Any person who would like to participate in revisions to an IEEE standard is welcome to join the relevant IEEE working group.

Comments on standards should be submitted to the following address:

Secretary, IEEE-SA Standards Board  
445 Hoes Lane  
Piscataway, NJ 08854 USA

## Laws and regulations

Users of IEEE Standards documents should consult all applicable laws and regulations. Compliance with the provisions of any IEEE Standards document does not imply compliance to any applicable regulatory requirements. Implementers of the standards are responsible for observing or referring to the applicable regulatory requirements. IEEE does not, by the publication of its standards, intend to urge action that is not in compliance with applicable laws, and these documents may not be construed as doing so.

## Copyrights

IEEE draft and approved standards are copyrighted by IEEE under U.S. and international copyright laws. They are made available by IEEE and are adopted for a wide variety of both public and private uses. These include both use by reference, in laws and regulations, and use in private self-regulation, standardization, and the promotion of engineering practices and methods. By making these documents available for use and adoption by public authorities and private users, IEEE does not waive any rights in copyright to the documents.

## Photocopies

Subject to payment of the appropriate fee, IEEE will grant users a limited, non-exclusive license to photocopy portions of any individual standard for company or organizational internal use or individual, non-commercial use only. To arrange for payment of licensing fees, please contact Copyright Clearance Center, Customer Service, 222 Rosewood Drive, Danvers, MA 01923 USA; +1 978 750 8400. Permission to photocopy portions of any individual standard for educational classroom use can also be obtained through the Copyright Clearance Center.

## Updating of IEEE Standards documents

Users of IEEE Standards documents should be aware that these documents may be superseded at any time by the issuance of new editions or may be amended from time to time through the issuance of amendments, corrigenda, or errata. An official IEEE document at any point in time consists of the current edition of the document together with any amendments, corrigenda, or errata then in effect.

Every IEEE standard is subjected to review at least every ten years. When a document is more than ten years old and has not undergone a revision process, it is reasonable to conclude that its contents, although still of some value, do not wholly reflect the present state of the art. Users are cautioned to check to determine that they have the latest edition of any IEEE standard.

In order to determine whether a given document is the current edition and whether it has been amended through the issuance of amendments, corrigenda, or errata, visit the IEEE-SA Website at <http://ieeexplore.ieee.org/xpl/standards.jsp> or contact IEEE at the address listed previously. For more information about the IEEE-SA or IEEE's standards development process, visit the IEEE-SA Website at <http://standards.ieee.org>.

## Errata

Errata, if any, for all IEEE standards can be accessed on the IEEE-SA Website at the following URL: <http://standards.ieee.org/findstds/errata/index.html>. Users are encouraged to check this URL for errata periodically.

## Patents

Attention is called to the possibility that implementation of this standard may require use of subject matter covered by patent rights. By publication of this standard, no position is taken by the IEEE with respect to the existence or validity of any patent rights in connection therewith. If a patent holder or patent applicant has filed a statement of assurance via an Accepted Letter of Assurance, then the statement is listed on the IEEE-SA Website at <http://standards.ieee.org/about/sasb/patcom/patents.html>. Letters of Assurance may indicate whether the Submitter is willing or unwilling to grant licenses under patent rights without compensation or under reasonable rates, with reasonable terms and conditions that are demonstrably free of any unfair discrimination to applicants desiring to obtain such licenses.

Essential Patent Claims may exist for which a Letter of Assurance has not been received. The IEEE is not responsible for identifying Essential Patent Claims for which a license may be required, for conducting inquiries into the legal validity or scope of Patents Claims, or determining whether any licensing terms or conditions provided in connection with submission of a Letter of Assurance, if any, or in any licensing agreements are reasonable or non-discriminatory. Users of this standard are expressly advised that determination of the validity of any patent rights, and the risk of infringement of such rights, is entirely their own responsibility. Further information may be obtained from the IEEE Standards Association.

## Participants

At the time this IEEE standard was completed, the Robot Map Data Representation (MDR) Working Group had the following membership:

**Wonpil Yu**, *Chair*  
**Francesco Amigoni**, *Vice Chair*

Torsten Andre  
Atsuhiko Banno  
Geoffrey Biggs  
Dirk Holz

Akiya Kamimura  
Rajmohan Madhavan  
Martin Magnusson

Matteo Matteucci  
Hyungpil Moon  
Masashi Yokotsuka  
Jae-Jun Yoo

The following members of the individual balloting committee voted on this standard. Balloters may have voted for approval, disapproval, or abstention.

Francesco Amigoni  
Keith Chow  
Sourav Dutta  
Paulo Goncalves  
Randall Groves  
Seo Ho

Werner Hoelzl  
Noriyuki Ikeuchi  
Sang-won Jeon  
Piotr Karocki  
Dong Han Kim  
Rajmohan Madhavan  
Hyungpil Moon

Robert Robinson  
Cristian Schindoff  
Wilson Silva, Jr.  
Walter Struppler  
Marcy Stutzman  
Wonpil Yu

When the IEEE-SA Standards Board approved this standard on 3 September 2015, it had the following membership:

**John D. Kulick**, *Chair*  
**Jon Walter Rosdahl**, *Vice Chair*  
**Richard H. Hulett**, *Past Chair*  
**Konstantinos Karachalios**, *Secretary*

Masayuki Ariyoshi  
Ted Burse  
Stephen Dukes  
Jean-Philippe Faure  
J. Travis Griffith  
Gary Hoffman  
Michael Janezic

Joseph L. Koepfinger\*  
David J. Law  
Hung Ling  
Andrew Myles  
T. W. Olsen  
Glenn Parsons  
Ronald C. Petersen  
Annette D. Reilly

Stephen J. Shellhammer  
Adrian P. Stephens  
Yatin Trivedi  
Phillip Winston  
Don Wright  
Yu Yuan  
Daidi Zhong

\*Member Emeritus

## Introduction

This introduction is not part of IEEE Std 1873™-2015, IEEE Standard for Robot Map Data Representation for Navigation.

This standard specifies map data models and formats for robot navigation tasks. The standard provides specifications for representing two-dimensional (2D) metric and topological maps. A recommendation for exchanging map data among robots, computers, and other devices is provided.

To this end, the standard:

- a) Defines a hierarchy of terminologies related to two-dimensional robot maps for navigation in indoor and outdoor environments;
- b) Specifies a data model for each element of the hierarchy; and
- c) Specifies an XML format for map data exchange between different robots, computer systems, and devices.

Three-dimensional, dynamic, and semantic maps are not considered in this standard, which is one possible extension thereof within the next few years to accommodate current technology development.

The rest of this section provides introduction to robot maps, including a few typical use cases of robot maps. The *map data representation* (MDR) is explained in conjunction with robot navigation in 2D indoor and outdoor environments. Technical issues are also introduced to highlight the needs for this standardization.

More specifically, the Background clause provides the background of MDR specifications. The Industry practices of MDR clause provides practical examples of robot navigation relevant to MDR specifications in the form of use cases. The Use case and benefit examples clause describes a typical use case in which a mobile robot utilizes a map for navigation tasks and indicates benefits that are obtained by standardization of MDR for robot navigation.

## Background

One of the basic elements of robot navigation is a map with which a mobile robot can perform localization and motion planning. In order for the mobile robot to operate properly, a map may need to be available a priori or constructed during operation. Figure a illustrates a generic structure of robot navigation technology, comprising localization, mapping, and motion control.

Metric maps are perhaps the most popular type of maps used in everyday activities; for example, city maps or maps used for hiking or orienteering. A metric map explicitly encodes the physical layout of a target space and positions of physical objects therein.

Metric maps can be subdivided into continuous or discrete metric maps. An orienteering map is an example of a continuous metric map, where lines, points, and other geometric symbols mark the positions and shapes of paths, rocks, and so on. An example of a pure point map is reported in Holz and Behnke [B4].<sup>a</sup> Points may also have associated uncertainty information, represented as a 2x2 covariance matrix, as in the Normal Distributions Transform (NDT) representation (Saarinen et al. [B8]) (see Figure b).

---

<sup>a</sup>The numbers in brackets correspond to those of the bibliography in Annex B.

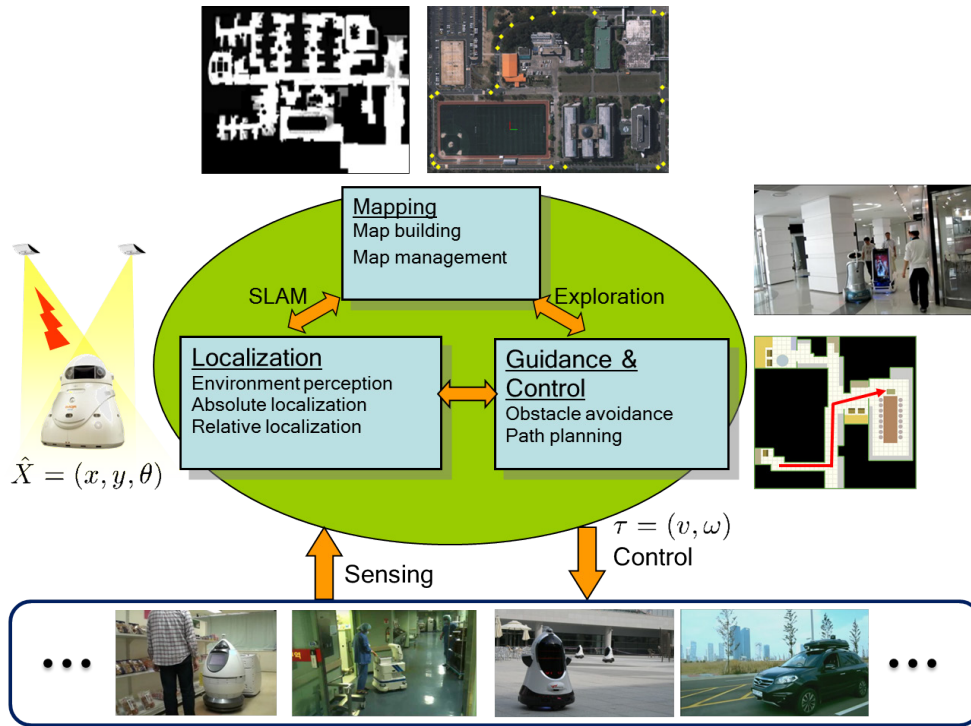

**Figure a—Structure of robot navigation technology**

Discrete metric maps are not so common for everyday human use, but are ubiquitous in robotics applications. They can be thought of as bitmap representations of, for example, the floor plan of a building, where the space is discretized by pixels to form a digital image thereof, where each pixel describes whether the corresponding part of the map belongs to the floor or wall of the space (Elfes [B2]; Moravec [B5]) (see Figure c).

A topological map represents an environment in the form of a graph consisting of a set of nodes (or vertices) and edges connecting the nodes (Choi et al. [B1]).

An everyday example of a topological map is the one commonly used for subway or bus networks, where primary information consists of nodes in the map (stations) and the connectivity between them (which subway or bus line goes between which stations). In this form of topological maps, relative positions and distances between map elements are less important. An example from robotics is a map of a building interior, where nodes in the map denote landmarks or distinctive features of the corresponding places, and edges represent possible routes for a mobile robot to navigate from one room to another (for example, see Figure d).

Once a physical environment is mapped to a topological map, path planning becomes a simple graph search. Also, topological representation is much more compact than metric maps. However, the drastic reduction in data comes at the cost of increased perceptual aliasing. Vertices of a topological map are augmented with various types of landmarks, requiring a proper interpretation of sensor readings to infer locations of a mobile robot. Reducing perceptual aliasing is critical for the success of robot navigation. Therefore, the data format should be defined so that various kinds of information can be included in the nodes and edges of a topological map to reduce the perceptual aliasing.

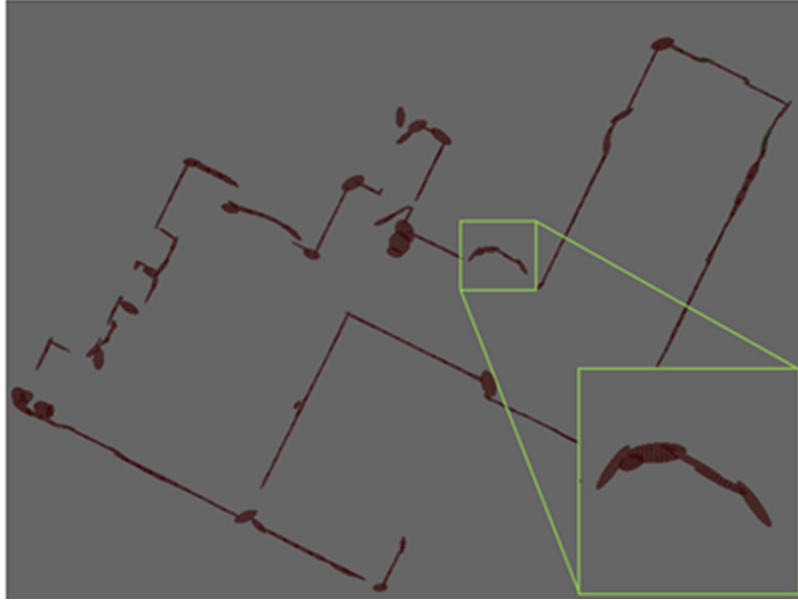

NOTE—Reprinted with permission from Todor Stoyanov.

**Figure b—Continuous metric map with confidence ellipsoids (i.e., a point with an associated covariance matrix), scaled and oriented according to the Gaussian probability of occupancy in the local neighborhood. The excerpt shows a magnified portion of the map.**



NOTE—Reprinted with permission from Zulqarnain Haider.

**Figure c—Discrete metric map, showing the interior of a furnished room. The grey level of each cell represents how likely it is to be free space. White means *certainly free*, black means *certainly occupied*, and mid-grey means *unknown*. In this example, colored cells (blue-yellow-red) also represent *occupied space*, and additionally store the temperature of the surface, as measured by a thermal camera.**

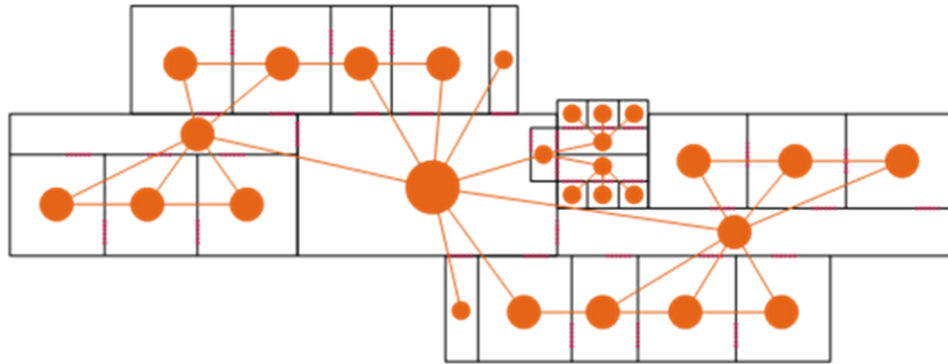

**Figure d—Example of a topological map**

There are various kinds of resources that can be used to develop a robot system providing a navigation capability. Examples include OpenSLAM (<http://openslam.org/>), Robot Operating System (ROS) (<http://wiki.ros.org/>), Mobile Robot Programming Toolkit (MRPT) (<http://www.mrpt.org/>), ORCA (<http://orca-robotics.sourceforge.net/>), Player and Stage (<http://playerstage.sourceforge.net/>), and many more from commercial software products. However, incompatibility among map data formats of the respective software tools makes reuse of existing software or integration of system components coming from different stakeholders a laborious task. This causes additional costs for developing robotics systems based on navigation and prevents service providers, possibly from other technical fields, from entering robotics industry.

A few *standard developing organizations* (SDOs) have already published a series of standards specifying application schemas for facilitating spatial data exchange, including Open Geospatial Consortium (OGC) City Geography Markup Language (CityGML) [B6] and Web Map Service (WMS) from OGC, and Geography Markup Language (GML) from ISO TC 211. The existing standards for encoding and exchanging spatial data, however, do not satisfy requirements specific to robotics: accuracy requirements and probabilistic nature of robot navigation. Moreover, previous Geographic Information System (GIS) standards concentrate on either metric or topological maps, not to mention the inadequacy of geographic scale in terms of robot navigation. For example, CityGML deals only with simple topological relationships (“contained in”) among spatial entities that carry their geometrical information, while WMS provides spatial maps only in the form of conventional graphic files: BMP, TIFF, JPEG, PNG, SVG, and the like.

Based on these findings, the MDR standard attempts to aggregate the existing spatial data encoding and exchanging practices, tailoring them to suit the requirements raised by robot navigation tasks in 2D indoor and outdoor environments: map quality in terms of metric accuracy, probabilistic behavior of robot navigation, and capability of handling metric and topological maps.

From the standpoint of (autonomous) mobile robotics, a map available to a mobile robot can come from several sources, including Simultaneous Localization and Mapping (SLAM), executive drawings or floor plans, and human mapping. The mobile robot can use the obtained map for many tasks, including motion planning, map update, localization, and obstacle avoidance. However, this document is only concerned with a common representation of environments, independently of its origin or purpose.

### **Industry practices of MDR**

This clause provides a few examples of industry practices of robot navigation, emphasizing the usage of map data. In fact, these examples illustrate realistic use cases of robotic services utilizing navigation functionality. It should be noted that the following examples are selected to highlight some present and future industry practices; therefore, they are not intended to limit the technical scope of this standard to the application areas illustrated therein.

Table a specifies a use case in which a mobile robot provides a transportation service at a shopping mall. The types of maps employed are a metric map, a topological map, and a floor plan crafted manually for a user interface.

**Table a—Robotic transportation service**

<b>Brief description</b>	A mobile robot transports purchased items to a place designated by a shopper in a large shopping mall. The robot also provides a guidance service to shoppers.
<b>Types of maps</b>	<ul style="list-style-type: none"> <li>—Metric map: the whole space is divided into a group of smaller-sized occupancy grid maps (10 m × 10 m). The grid maps are generated from a scanning laser sensor mounted on the robot, each cell of which is 1 cm × 1 cm.</li> <li>—Topological map storing visual features: consists of Speeded Up Robust Features (SURF) feature vectors (64 dimensions) and their positions (3 <i>dimensions</i>).</li> <li>—Floor plan crafted manually.</li> </ul>
<b>Usage of maps</b>	<ul style="list-style-type: none"> <li>—Metric map and topological map: self-localization of a mobile robot; specifically, metric map for accurate localization in a local area and topological map for global localization.</li> <li>—Floor plan map: user interface for people.</li> </ul>

Table b specifies a use case in which a mobile robot performs a surveillance task along the perimeter of an airport.

**Table b—Robotic surveillance system**

<b>Brief description</b>	A mobile robot, equipped with a 2D laser scanner and a stereo camera, performs surveillance and patrol tasks in a facility complex.
<b>Types of maps</b>	<ul style="list-style-type: none"> <li>—Metric map #1: 2D occupancy grid map is used for representing an outdoor environment. The map is generated by a 2D laser scanner sensor.</li> <li>—Metric map #2: 3D voxel map is used.<sup>a</sup> The map is generated by a stereo camera system. About 200 MB memory is required to cover a 100 m × 40 m area with 0.1 m resolution.</li> </ul>
<b>Usage of maps</b>	<ul style="list-style-type: none"> <li>—Metric map #1: ground vehicle navigation (including obstacle avoidance and path planning).</li> <li>—Metric map #2: ground vehicle localization and tele-operation (remote sensing).</li> </ul>

<sup>a</sup> A voxel is an atomic element (e.g., a cubic cell) of a regular grid in the three-dimensional space.

Table c specifies a use case in which a group of mobile robots share a 2D metric, semantic,<sup>b</sup> and topological map to provide a delivery service in a large-scale hospital environment.

<sup>b</sup> A semantic map for a mobile robot is a map that integrates spatial information encoding the surroundings of the mobile robot and semantic knowledge (human-level knowledge, like the names and functions of the rooms) about the surrounding environment (Galindo et al. [B3]).

**Table c—Hospital delivery robot**

<b>Brief description</b>	A mobile robot equipped with two 2D laser scanners (at middle and lower part of the robot platform) and six ultrasonic sensors is used for medical equipment or items delivery in a large-scale hospital environment.
<b>Types of maps</b>	<ul style="list-style-type: none"> <li>—Metric map: 2D occupancy grid map generated by two 2D laser scanner sensors.</li> <li>—Semantic map: a dedicated grid map describing classified area information in a hospital is generated from the 2D occupancy grid map.</li> <li>—Topological map: node registration by using infrared retro-reflective markers attached on the ceiling. SLAM is used to estimate a robot pose, which is eventually utilized to derive node poses.</li> </ul>
<b>Usage of maps</b>	<ul style="list-style-type: none"> <li>—2D occupancy grid map: indoor robot localization.</li> <li>—Semantic map: task, path, and motion planning.</li> <li>—Topological map: a user interface between the robot and the user.</li> </ul>

**Use case and benefit examples**

This clause presents an example of a use case for MDR. Figure e is a block diagram illustrating the relationship among various components of a map system specific to robot navigation functionality. In fact, the block diagram shows conceptual scenarios of a map creation use case [with associated steps from 1) to 4)] and a map retrieval use case [with associated steps from 6) to 8)] at the same time.

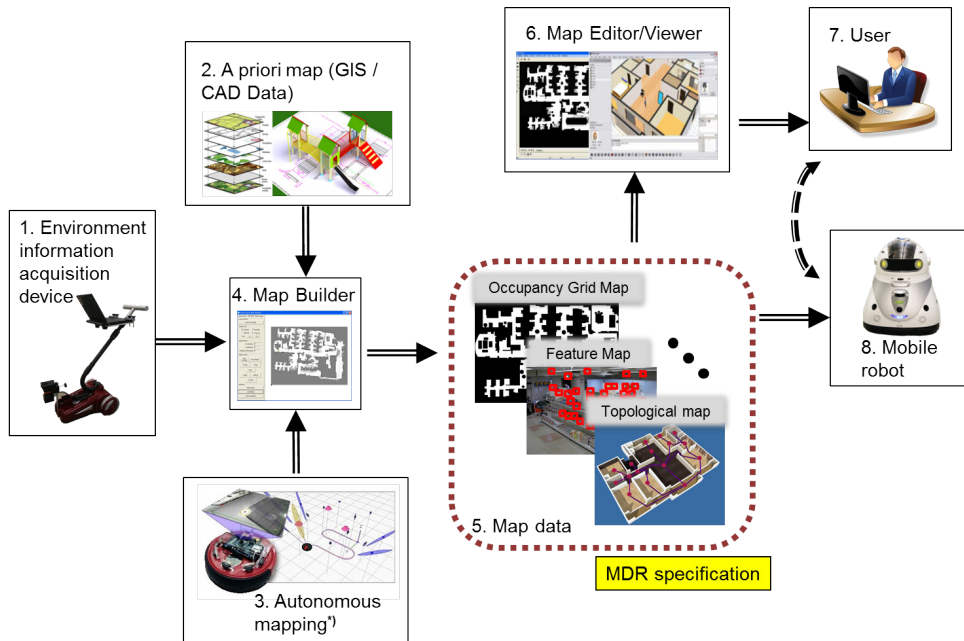

NOTE—\*Reprinted with permission from Jae-Bok Song.

**Figure e—Block diagram illustrating generation and use of a map for robot navigation**

- 1) Environment information acquisition device: a robot, a specially designed mapping device, a surveying tool, or any kind of equipment used by a human for gathering structural information of the environment in question manually or semi-autonomously.
- 2) A priori map: a map possibly provided a priori in the form of CAD drawings or other relevant format describing the environmental structures.

- 3) **Autonomous mapping:** a robot or any kind of device capable of gathering environmental information autonomously by employing, for example, a Simultaneous Localization and Mapping (SLAM) algorithm.
- 4) **Map builder:** a software system that is used by a human or by an algorithm to construct a map after spatial data acquisition, refining the initial maps built from manual, semi-autonomous, or autonomous mapping. The map builder can be located in any place as long as an external request for the constructed map can be handled, for example, in the internal memory of a robot or an external computer.
- 5) **Map data:** metric or topological maps conforming to the MDR specification.
- 6) **Map editor/viewer:** a software system used by a human to edit, revise, or display maps for a particular robot application.
- 7) **User:** a developer or an end-user who actually uses the map for task monitoring or robot control purpose.
- 8) **Mobile robot:** a hardware platform that performs a navigation task by using the map constructed. The mobile robot can perform map merging or sharing depending on task requirements. This mobile robot can be the same robot used in the step 3 or a different one.

The benefits that can be obtained from the MDR standard can be described as follows.

- a) **To provide a common spatial representation for various types of robot systems employing navigation functionality:** The primary benefit of this standard is that robot maps are represented in a common data model so that development and deployment of various robotic applications based on robot navigation can be facilitated. Such applications include, but are not limited to, autonomous road navigation, robotic logistic systems, robots for defense and rescue, and service robots for personal/domestic applications such as robotic vacuum cleaners and entertainment robots.
- b) **To facilitate robotics technology development:** The MDR standard will contribute to promote development of good experimental methodologies for mobile robotics as a valuable tool for facilitating comparison and evaluation of maps obtained with different systems.
- c) **To reduce development and deployment costs:** Complying with a standard for MDR makes vendor's components more compatible with others and therefore makes their products more desirable and more likely to win contracts. Standards compliance is particularly important in environments where devices from diverse vendors inter-operate, such as factories and military environments, where data interchange is a common occurrence.

## Contents

1. Overview .....	1
1.1 Scope .....	1
1.2 Purpose .....	2
2. Normative references.....	2
3. Definitions, acronyms, and abbreviations .....	3
3.1 Coordinate systems and transformations .....	3
3.2 Maps .....	4
3.3 Map components.....	5
3.4 Map usage.....	5
3.5 Acronyms and abbreviations .....	6
4. Conventions.....	6
5. Map data representation for robot navigation.....	7
5.1 Data format for metric maps.....	11
6. Exchange interface for map data .....	20
6.1 Implementation standard specific extensions .....	20
6.2 LocalMap.....	20
6.3 MapArray .....	22
6.4 GridMap .....	24
6.5 GeometricMap .....	25
6.6 TopologicalMap.....	26
Annex A (informative) XML sample of map data .....	29
Annex B (informative) Bibliography.....	36



# IEEE Standard for Robot Map Data Representation for Navigation

***IMPORTANT NOTICE: IEEE Standards documents are not intended to ensure safety, security, health, or environmental protection, or ensure against interference with or from other devices or networks. Implementers of IEEE Standards documents are responsible for determining and complying with all appropriate safety, security, environmental, health, and interference protection practices and all applicable laws and regulations.***

***This IEEE document is made available for use subject to important notices and legal disclaimers. These notices and disclaimers appear in all publications containing this document and may be found under the heading “Important Notice” or “Important Notices and Disclaimers Concerning IEEE Documents.” They can also be obtained on request from IEEE or viewed at <http://standards.ieee.org/IPR/disclaimers.html>.***

## 1. Overview

This standard specifies a common representation of two-dimensional (2D) maps intended for mobile robot navigation in indoor and outdoor environments.

### 1.1 Scope

This standard provides specifications for representing 2D metric and topological maps. This standard defines a recommended format for exchanging map data among robots, computers, and other devices. The map representation format specified by this standard only considers static maps; in other words, moving objects are not explicitly represented in the maps. Additionally, no limit is placed on geographic scale or sensor modalities in applying this standard.

To this end, the standard:

- a) Defines a hierarchy of terminologies related to 2D robot maps for navigation in indoor and outdoor environments;
- b) Specifies a data model for each element of the hierarchy; and
- c) Specifies an XML format for map data exchange between different robots, computer systems, and devices.

There are several standards related to map specifications already published or under development from other *standard developing organizations* (SDOs), including the International Organization for