

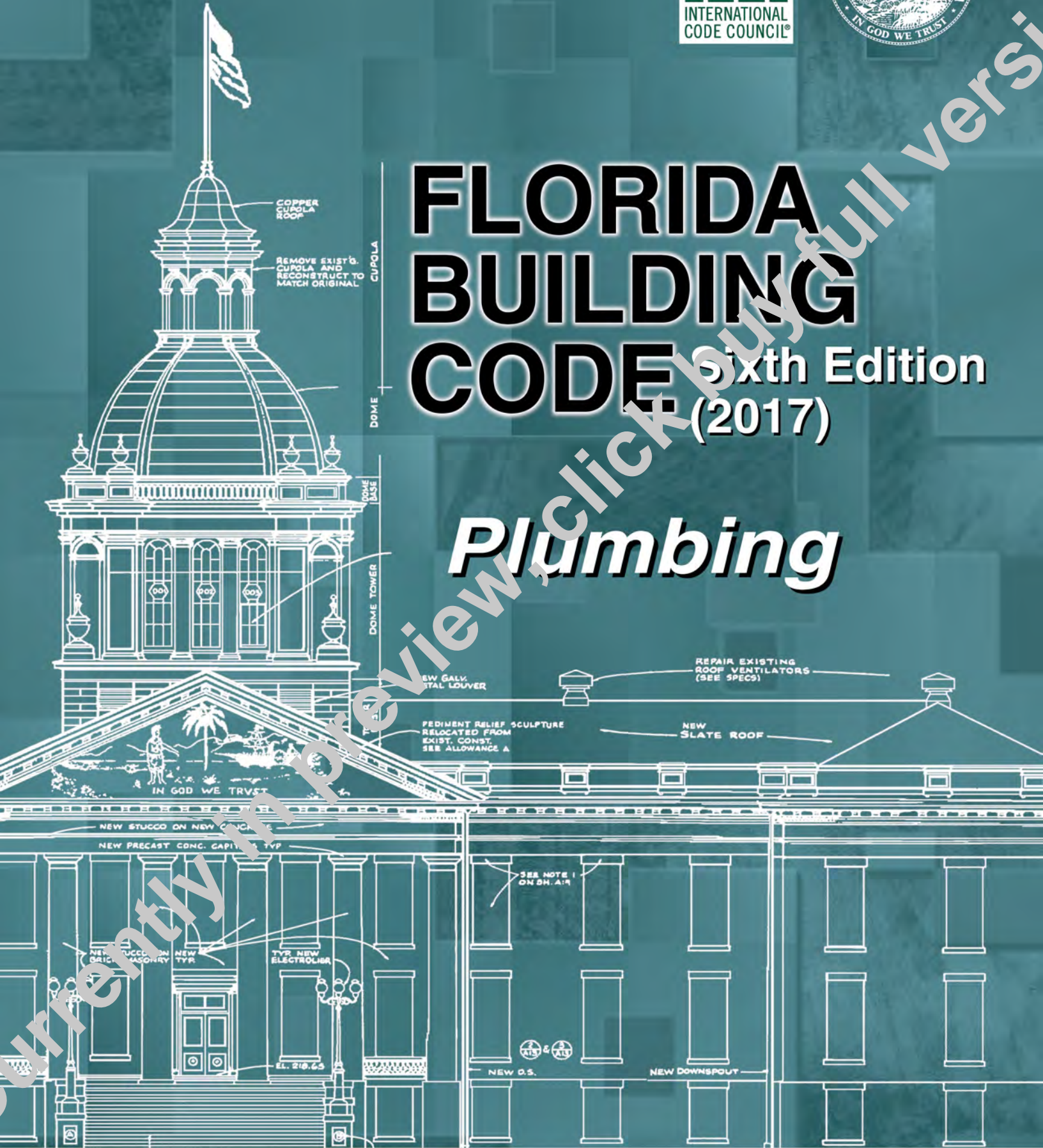

FLORIDA BUILDING CODE

Sixth Edition
(2017)

Plumbing



Currently in preview, click to buy full version

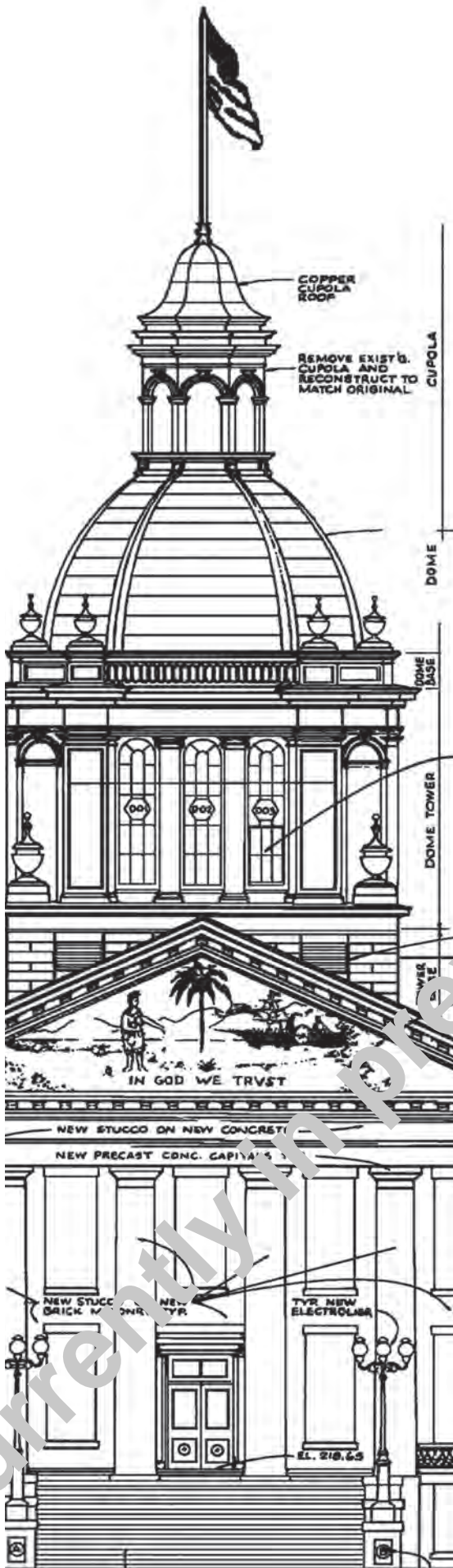

FLORIDA BUILDING CODE

Sixth Edition
(2017)

Plumbing

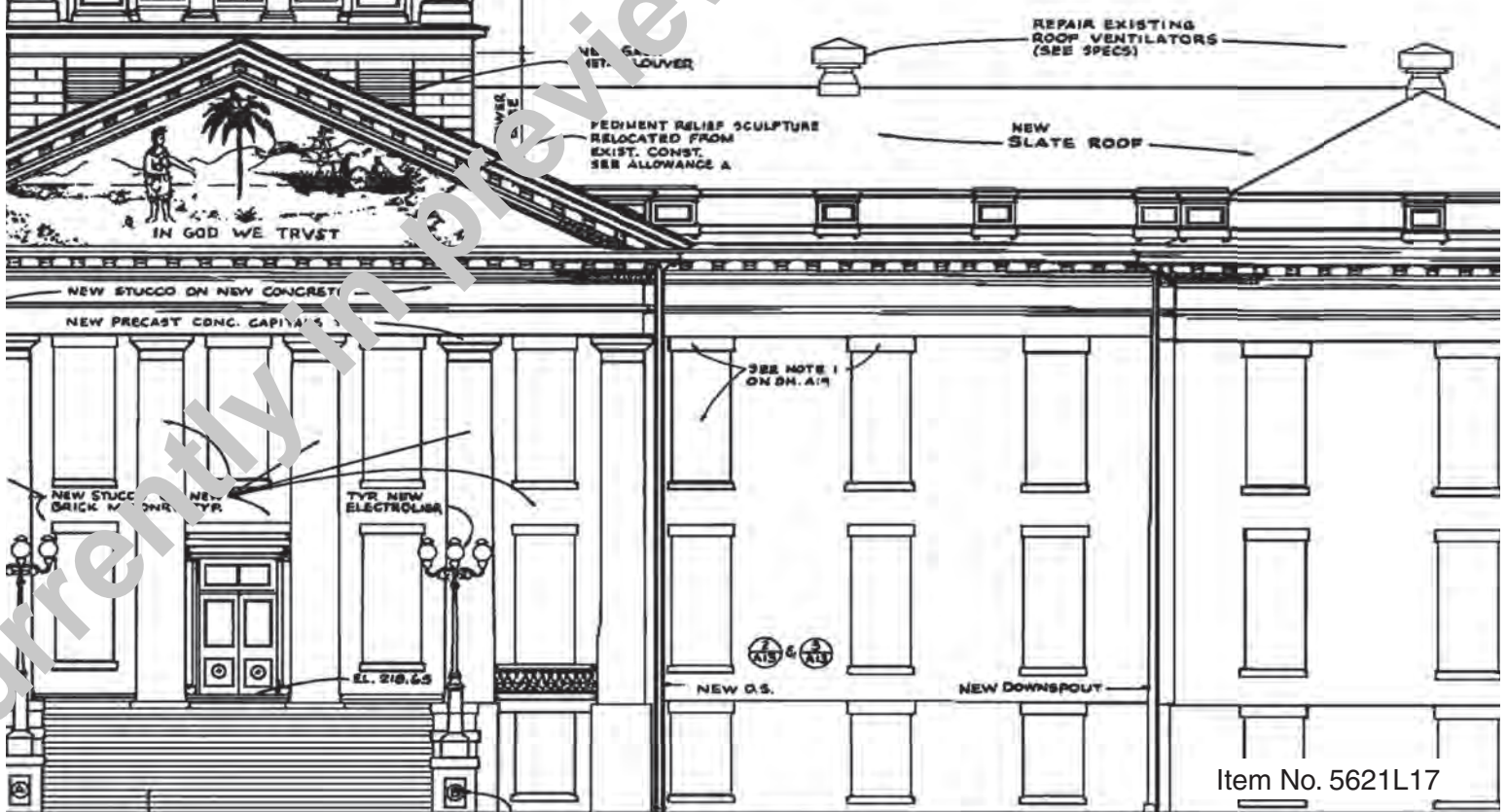

Florida Building Code, Plumbing, 6th Edition

First Printing: July 2017

ISBN: 978-1-60983-689-4

COPYRIGHT © 2017
by
INTERNATIONAL CODE COUNCIL, INC.

ALL RIGHTS RESERVED. This *Florida Building Code, Plumbing, 6th Edition* (2017) contains substantial copyrighted materials from the 2015 *International Plumbing Code*®, 3rd printing, which is a copyrighted work owned by the International Code Council, Inc., that is © 2015 International Code Council, Inc. ALL RIGHTS RESERVED. Without advance written permission from the copyright owner, no part of this work may be reproduced, distributed or transmitted in any form or by any means, including, without limitation, electronic, optical or mechanical means (by way of example, and not limitation, photocopying, or recording or by an information storage retrieval system). For information on use rights and permissions, please contact: Publications, 1051 Crossmoor Road, Country Club Hills, IL 60478. Phone 1-888-ICC-SAFE (422-7233).

The following trademarks: “International Code Council,” the “International Code Council” logo, “ICC,” the “ICC” logo, the “International Plumbing Code,” and the “IPC” are trademarks of the International Code Council, Inc., and may not be used without permission.

PRINTED IN THE U.S.A.

PREFACE

History

The State of Florida first mandated statewide building codes during the 1970s at the beginning of the modern construction boom. The first law required all municipalities and counties to adopt and enforce one of the four state-recognized model codes known as the “state minimum building codes.” During the early 1990s a series of natural disasters, together with the increasing complexity of building construction regulation in vastly changed markets, led to a comprehensive review of the state building code system. The study revealed that building code adoption and enforcement was inconsistent throughout the state and those local codes thought to be the strongest proved inadequate when tested by major hurricane events. The consequences of the building code system failure were devastation to lives and economies and a statewide property insurance crisis. The response was a reform of the state building construction regulatory system that placed emphasis on uniformity and accountability.

The 1998 Florida Legislature amended Chapter 553, *Florida Statutes* (FS), Building Construction Standards, to create a single state building code that is enforced by local governments. As of March 1, 2002, the *Florida Building Code*, which is developed and maintained by the Florida Building Commission, supersedes all local building codes. The *Florida Building Code* is updated every three years and may be amended annually to incorporate interpretations and clarifications.

Scope

The *Florida Building Code* is based on national model building codes and national consensus standards which are amended where necessary for Florida’s specific needs. However, code requirements that address snow loads and earthquake protection are pervasive; they are left in place but should not be utilized or enforced because Florida has no snow load or earthquake threat. The code incorporates all building construction-related regulations for public and private buildings in the State of Florida other than those specifically exempted by Section 553.73, *Florida Statutes*. It has been harmonized with the *Florida Fire Prevention Code*, which is developed and maintained by the Department of Financial Services, Office of the State Fire Marshal, to establish unified and consistent standards.

The base codes for the sixth edition (2017) of the *Florida Building Code* include: the *International Building Code*®, 2015 edition; the *International Plumbing Code*®, 2015 edition; the *International Mechanical Code*®, 2015 edition; the *International Fuel Gas Code*®, 2015 edition; the *International Residential Code*®, 2012 edition; the *International Existing Building Code*®, 2015 edition; the *International Energy Conservation Code*®, 2015; the *National Electrical Code*, 2014 edition; substantive criteria from ASHRAE Standard 90.1-2013. State and local codes adopted and incorporated into the code include the *Florida Building Code, Accessibility*, and special hurricane protection standards for the High-Velocity Hurricane Zone.

The code is composed of nine main volumes: the *Florida Building Code, Building*, which also includes state regulations for licensed facilities; the *Florida Building Code, Plumbing*; the *Florida Building Code, Mechanical*; the *Florida Building Code, Fuel Gas*; the *Florida Building Code, Existing Building*; the *Florida Building Code, Residential*; the *Florida Building Code, Energy Conservation*; the *Florida Building Code, Accessibility* and the *Florida Building Code, Test Protocols for High-Velocity Hurricane Zones*. Chapter 27 of the *Florida Building Code, Building*, adopts the *National Electrical Code*, NFPA 70, by reference.

Under certain strictly defined conditions, local governments may amend requirements to be more stringent than the code. All local amendments to the *Florida Building Code* must be adopted by local ordinance and reported to the Florida Building Commission, then posted on www.floridabuilding.org in Legislative format for a month before being enforced. Local amendments to the *Florida Building Code* and the *Florida Fire Prevention Code* may be obtained from the Florida Building Commission web site, or from the Florida Department of Business and Professional Regulation or the Florida Department of Financial Services, Office of the State Fire Marshal, respectively.

Adoption and Maintenance

The *Florida Building Code* is adopted and updated with new editions triennially by the Florida Building Commission. It is amended annually to incorporate interpretations, clarifications and to update standards. Minimum requirements for permitting, plans review and inspections are established by the code, and local jurisdictions may adopt additional administrative requirements that are more stringent. Local technical amendments are subject to strict criteria established by Section 553.73, FS. They are subject to Commission review and adoption into the code or repeal when the code is updated triennially and are subject to appeal to the Commission according to the procedures established by Section 553.73, FS.

Eleven Technical Advisory Committees (TACs), which are constituted consistent with American National Standards Institute (ANSI) Guidelines, review proposed code changes and clarifications of the code and make recommendations to the Commission. These TACs whose members are constituted consistent with ANSI Guidelines include: Accessibility; Joint Building Fire (a joint committee of the Commission and the State Fire Marshal); Building Structural; Code Administration/Enforcement; Electrical; Energy; Mechanical; Plumbing and Fuel Gas; Roofing; Swimming Pools and Special Occupancy (state agency construction and facility licensing regulations).

The Commission may only issue official code clarifications using procedures of Chapter 120, *Florida Statutes*. To obtain such a clarification, a request for a Declaratory Statement (DEC) must be made to the Florida Building Commission in a manner that establishes a clear set of facts and circumstances and identifies the section of the code in question. Requests are analyzed by staff, reviewed by the appropriate Technical Advisory Committee, and sent to the Florida Building Commission for action. These interpretations establish precedents for situations having similar facts and circumstances and are typically incorporated into the code in the next code amendment cycle. Non-binding opinions are available from the Building Officials Association of Florida's web site (www.BOAF.net) and a Binding Opinion process is available online at www.floridabuilding.org.

Code Development Committee Responsibilities (Letter Designations in Front of Section Numbers)

In each code development cycle, proposed changes to the code are considered at the Committee Action Hearings by the International Plumbing Code Development Committee, whose action constitutes a recommendation to the voting membership for final action on the proposed change. Proposed changes to a code section that has a number beginning with a letter in brackets are considered by a different code development committee. For example, proposed changes to code sections that have [BS] in front of them (e.g., [BS] 309.2) are considered by the IBC – Structural Code Development Committee at the code development hearings.

The content of sections in this code that begin with a letter designation is maintained by another code development committee in accordance with the following:

- [A] = Administrative Code Development Committee;
- [BE] = IBC – Means of Egress Code Development Committee;
- [BG] = IBC – General Code Development Committee;
- [BS] = IBC – Structural Code Development Committee;
- [E] = International Energy Conservation Code Development Committee;
- [F] = International Fire Code Development Committee; and
- [M] = International Mechanical Code Development Committee.

Marginal Markings

Solid vertical lines in the margins within the body of the code indicate a technical change from the requirements of the 2012 edition. Deletion indicators in the form of an arrow (➡) are provided in the margin where an entire section, paragraph, exception or table has been deleted or an item in a list of items or a table has been deleted.

A single asterisk [*] placed in the margin indicates that text or a table has been relocated within the code. A double asterisk [**] placed in the margin indicates that the text or table immediately following it has been relocated there from elsewhere in the code.

Dotted vertical lines in the margins within the body of the code indicate a change from the requirements of the base codes to the *Florida Building Code, Plumbing, 6th Edition (2017)* effective December 31, 2017.

Sections deleted from the base code are designated “Reserved” in order to maintain the structure of the base code.

Italicized Terms

Selected terms set forth in Chapter 2, Definitions, are italicized where they appear in code text. Such terms are not italicized where the definition set forth in Chapter 2 does not impart the intended meaning in the use of the term. The terms selected have definitions that the user should read carefully to facilitate better understanding of the code.

Acknowledgments

The *Florida Building Code* is produced through the efforts and contributions of building designers, contractors, product manufacturers, regulators and other interested parties who participate in the Florida Building Commission’s consensus processes, Commission staff and the participants in the national model code development processes.

Currently in preview, click buy full version

TABLE OF CONTENTS

<p>CHAPTER 1 SCOPE AND ADMINISTRATION . . . 1</p> <p>PART 1—SCOPE AND APPLICATION 1</p> <p>Section</p> <p>101 General 1</p> <p>102 Applicability (Reserved) 1</p> <p>PART 2—ADMINISTRATION AND ENFORCEMENT 1</p> <p>Section</p> <p>103 Department of Plumbing Inspection (Reserved) 1</p> <p>104 Duties and Powers of the Code Official (Reserved) 1</p> <p>105 Approval (Reserved) 1</p> <p>106 Permits (Reserved) 1</p> <p>107 Inspections and Testing (Reserved) 1</p> <p>108 Violations (Reserved) 1</p> <p>109 Means of Appeal (Reserved) 1</p> <p>110 Temporary Equipment, Systems and Uses (Reserved) 1</p> <p>CHAPTER 2 DEFINITIONS 3</p> <p>Section</p> <p>201 General 3</p> <p>202 General Definitions 3</p> <p>CHAPTER 3 GENERAL REGULATIONS 11</p> <p>Section</p> <p>301 General 11</p> <p>302 Exclusion of Material Detrimental to the Sewer System 11</p> <p>303 Materials 11</p> <p>304 Rodentproofing 12</p> <p>305 Protection of Pipes and Plumbing System Components 12</p> <p>306 Trenching, Excavation and Backfill 12</p> <p>307 Structural Safety 13</p> <p>308 Piping Support 13</p> <p>309 Flood Hazard Resistance 14</p> <p>310 Washroom and Toilet Room Requirements 15</p> <p>311 Toilet Facilities for Workers 15</p>	<p>312 Tests and Inspections 15</p> <p>313 Equipment Efficiencies 16</p> <p>314 Condensate Disposal 17</p> <p>315 Penetrations 17</p> <p>316 Alternative Engineered Design 17</p> <p>317 Public Food Service Establishments and Food Establishments 18</p> <p>318 Irrigation 18</p> <p>CHAPTER 4 FIXTURES, FAUCETS AND FIXTURE FITTINGS 19</p> <p>Section</p> <p>401 General 19</p> <p>402 Fixture Materials 19</p> <p>403 Minimum Plumbing Facilities 19</p> <p>404 Accessible Plumbing Facilities 24</p> <p>405 Installation of Fixtures 24</p> <p>406 Automatic Clothes Washers 25</p> <p>407 Bathtubs 25</p> <p>408 Bidets 25</p> <p>409 Dishwashing Machines 25</p> <p>410 Drinking Fountains 25</p> <p>411 Emergency Showers and Eyewash Stations 26</p> <p>412 Floor and Trench Drains 26</p> <p>413 Food Waste Disposer Units 26</p> <p>414 Garbage Can Washers 26</p> <p>415 Laundry Trays 26</p> <p>416 Lavatories 26</p> <p>417 Showers 27</p> <p>418 Sinks 28</p> <p>419 Urinals 28</p> <p>420 Water Closets 28</p> <p>421 Whirlpool Bathtubs 28</p> <p>422 Health Care Fixtures and Equipment 29</p> <p>423 Specialty Plumbing Fixtures 29</p> <p>424 Faucets and Other Fixture Fittings 29</p> <p>425 Flushing Devices for Water Closets and Urinals 30</p> <p>426 Manual Food and Beverage Dispensing Equipment 31</p> <p>427 Floor Sinks 31</p>
--------------------------------------------------------------------------------------------------------------------------------------------------------------------------------------------------------------------------------------------------------------------------------------------------------------------------------------------------------------------------------------------------------------------------------------------------------------------------------------------------------------------------------------------------------------------------------------------------------------------------------------------------------------------------------------------------------------------------------------------------------------------------------------------------------------------------------------------------------------------------------------------------------------------------------------------------------------------------------------------------------------------------------------------------------------------------------------------------------------------------------------------------------------------------------------------------------------------------------------------------------------------------------------------------------------------------------------------------------------------------------------------------------------------------------------------------------------------------------------------------------------------------------------------------------------------	--------------------------------------------------------------------------------------------------------------------------------------------------------------------------------------------------------------------------------------------------------------------------------------------------------------------------------------------------------------------------------------------------------------------------------------------------------------------------------------------------------------------------------------------------------------------------------------------------------------------------------------------------------------------------------------------------------------------------------------------------------------------------------------------------------------------------------------------------------------------------------------------------------------------------------------------------------------------------------------------------------------------------------------------------------------------------------------------------------------------------------------------------------------------------------------------------------------------------------------------------------------------------------------------------------------------------------------------------------------------------------------------------------------------------------------------------------------------------------------------------------------------------------------------------------------------------------------------------------------------------------------------------------------------------------------------------------------------------------------

TABLE OF CONTENTS

CHAPTER 5 WATER HEATERS 33

Section

501 General 33

502 Installation 33

503 Connections 33

504 Safety Devices 34

505 Insulation 34

CHAPTER 6 WATER SUPPLY AND DISTRIBUTION 35

Section

601 General 35

602 Water Required 35

603 Water Service 36

604 Design of Building Water Distribution System 36

605 Materials, Joints and Connections 38

606 Installation of the Building Water Distribution System 44

607 Hot Water Supply System 45

608 Protection of Potable Water Supply 46

609 Health Care Plumbing 51

610 Disinfection of Potable Water System 52

611 Water Treatment Units 52

612 Solar Systems 52

613 Temperature Control Devices and Valves 52

614 Well Pumps and Tanks Used for Private Potable Water Systems 53

CHAPTER 7 SANITARY DRAINAGE 55

Section

701 General 55

702 Materials 55

703 Building Sewer 57

704 Drainage Piping Installation 57

705 Joints 57

706 Connections between Drainage Piping and Fittings 60

707 Prohibited Joints and Connections 61

708 Cleanouts 61

709 Fixture Units 62

710 Drainage System Sizing 62

711 Offsets in Drainage Piping in Buildings of Five Stories or More 64

712 Sumps and Ejectors 64

713 Health Care Plumbing 65

714 Computerized Drainage Design 67

715 Backwater Valves 67

716 Vacuum Drainage Systems 67

717 Replacement of Underground Sewers by Pipe-bursting Methods 68

CHAPTER 8 INDIRECT/SPECIAL WASTE 69

Section

801 General 69

802 Indirect Wastes 69

803 Special Wastes 70

804 Materials, Joints and Connections 70

CHAPTER 9 VENTS 71

Section

901 General 71

902 Materials 71

903 Vent Terminals 71

904 Outdoor Vent Extensions 71

905 Vent Connections and Grades 72

906 Vent Pipe Sizing 72

907 Vents for Stack Offsets 72

908 Relief Vents—Stacks of More Than 10 Branch Intervals 74

909 Fixture Vents 74

910 Individual Vent 74

911 Common Vent 74

912 Wet Venting 75

913 Waste Stack Vent 75

914 Circuit Venting 76

915 Combination Waste and Vent System 76

916 Island Fixture Venting 76

917 Single Stack Vent System 77

918 Air Admittance Valves 78

919 Engineered Vent Systems 78

920 Computerized Vent Design 79

CHAPTER 10 TRAPS, INTERCEPTORS AND SEPARATORS 81

Section

1001 General 81

1002 Trap Requirements 81

1003 Interceptors and Separators 82

1004 Materials, Joints and Connections 84

CHAPTER 11 STORM DRAINAGE 85

Section

1101 General 85

1102 Materials 85

1103 Traps 86

1104 Conductors and Connections 86

1105 Roof Drains 86

1106 Size of Conductors, Leaders and Storm Drains 86

1107 Siphonic Roof Drainage Systems 92

1108 Secondary (Emergency) Roof Drains 92

1109 Combined Sanitary and Storm Public Sewer ... 93

1110 Controlled Flow Roof Drain Systems 93

1111 Subsoil Drains 93

1112 Building Subdrains 94

1113 Sumps and Pumping Systems 94

CHAPTER 12 SPECIAL PIPING AND STORAGE SYSTEMS 95

Section

1201 General 95

1202 Medical Gases 95

1203 Oxygen Systems 95

CHAPTER 13 NONPOTABLE WATER SYSTEMS 97

Section

1301 General 97

1302 On-site Nonpotable Water Reuse Systems 99

1303 Nonpotable Rainwater Collection and Distribution Systems 101

1304 Reclaimed Water System 103

CHAPTER 14 SUBSURFACE LANDSCAPE IRRIGATION SYSTEMS 105

Section

1401 General 105

1402 System Design and Sizing 105

1403 Installation 106

CHAPTER 15 REFERENCED STANDARDS 109

APPENDIX A PLUMBING PERMIT FEE SCHEDULE 121

Permit Issuance 121

Unit Fee Schedule 121

Other Inspections and Fees 121

APPENDIX B RATES OF RAINFALL FOR VARIOUS CITIES 123

APPENDIX C STRUCTURAL SAFETY 125

Section

C101 Cutting, Notching and Boring in Wood Members 125

APPENDIX D DEGREE DAY AND DESIGN TEMPERATURES 127

APPENDIX E SIZING OF WATER PIPING SYSTEM 133

Section

E101 General 133

E102 Information Required 133

E103 Selection of Pipe Size 133

E201 Selection of Pipe Size 150

E202 Determination of Pipe Volumes 150

APPENDIX F PROPOSED CONSTRUCTION BUILDING CODES FOR TURF AND LANDSCAPE IRRIGATION SYSTEMS 155

INDEX 167